



MetroWest+

Portishead Branch Line (MetroWest Phase 1)

TR040011

Applicant: North Somerset District Council

2.48 - Ashton Vale Road Pedestrian Ramp Design Plan

**The Infrastructure Planning (Applications: Prescribed Forms and Procedure) Regulations 2009, regulation 5(2)(o)
Planning Act 2008**

Author: CH2M

Date: November 2019



Document Index

2.48	Ashton Vale Road Pedestrian Ramp Design Plan	The Infrastructure Planning (Applications: Prescribed Forms and Procedure) Regulations 2009, regulation 5(2)(o)	467470.BQ.04.20-SK34 Rev B
------	--	---	----------------------------

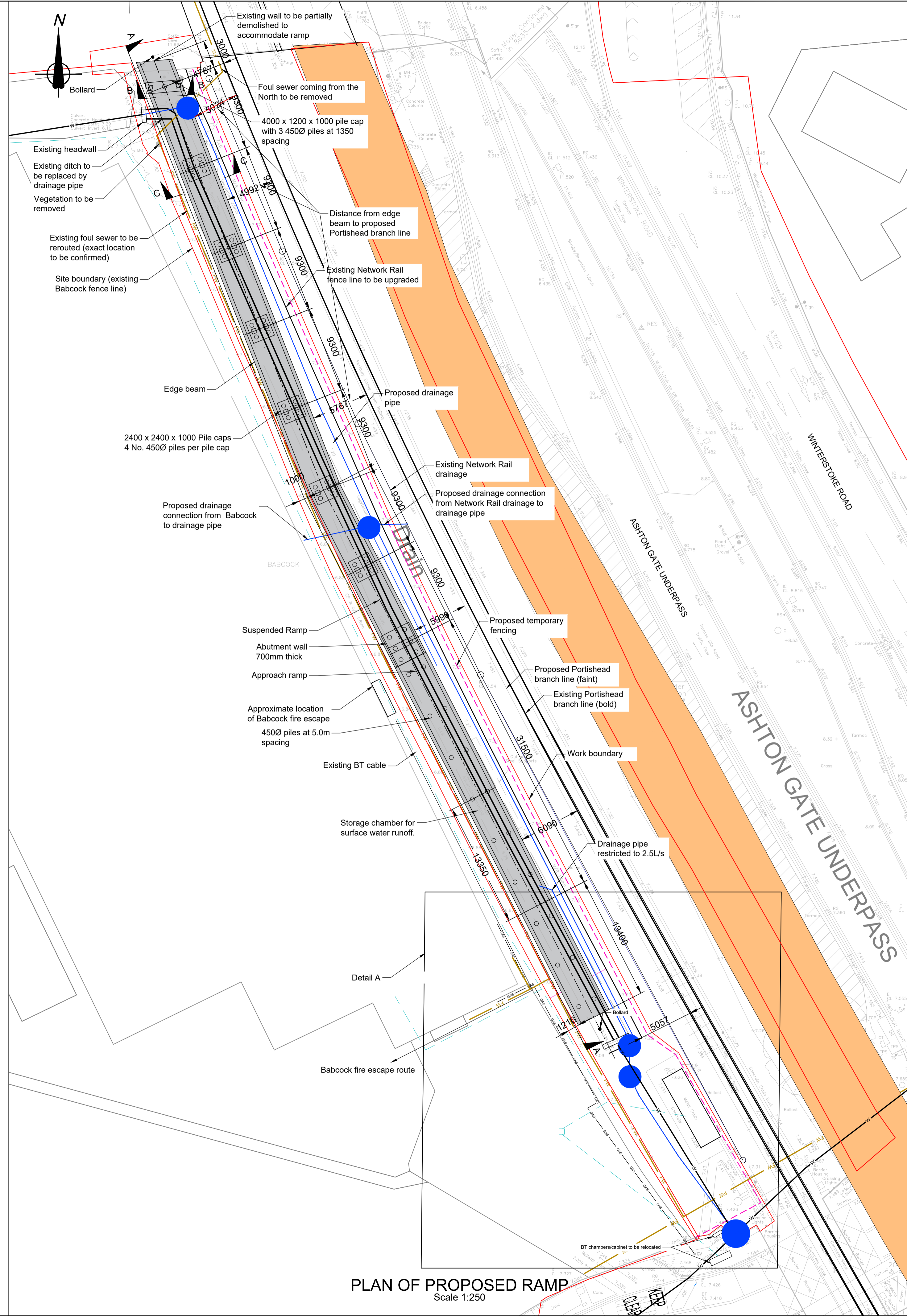

PLAN OF PROPOSED RAMP
Scale 1:250

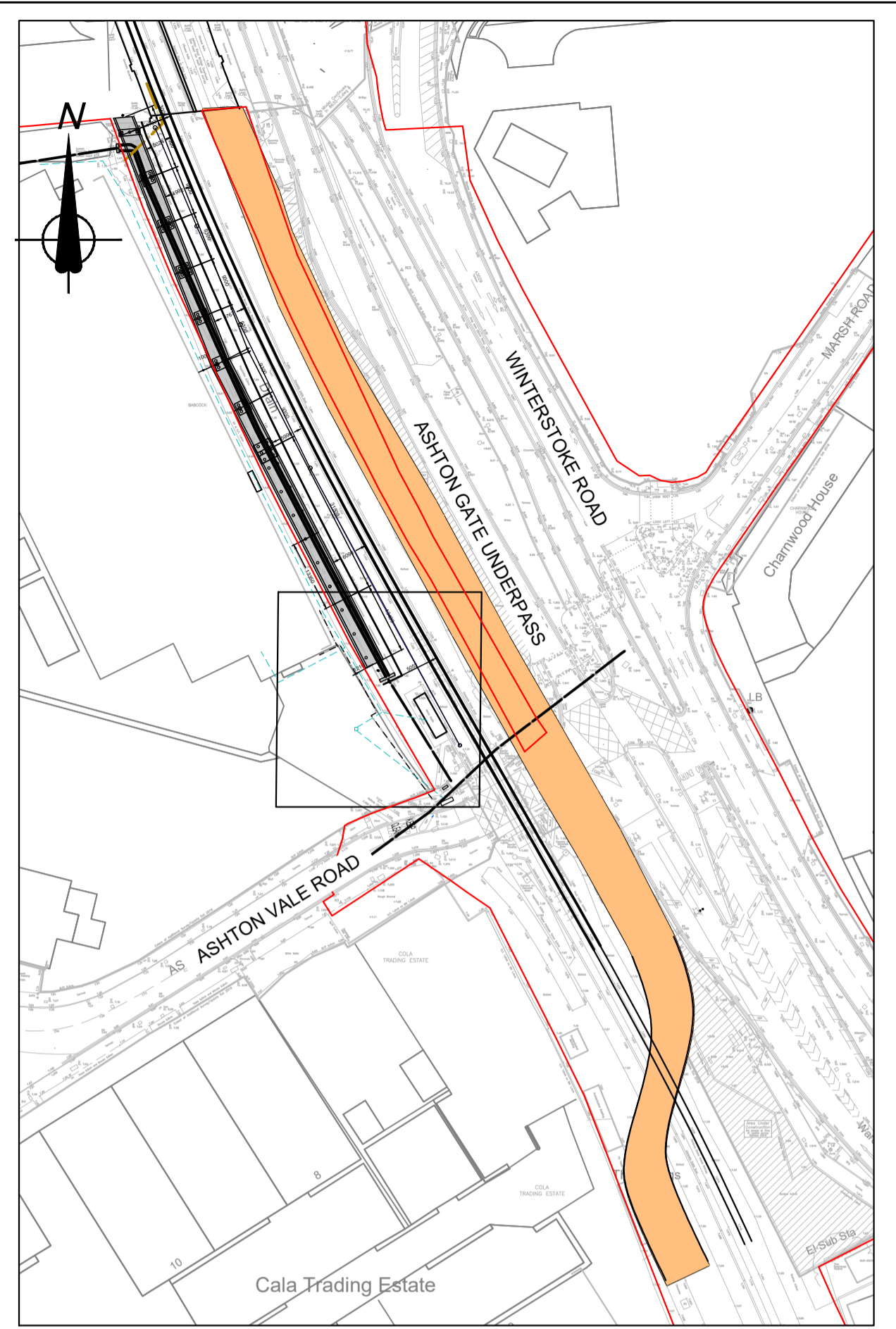

LOCATION PLAN
Scale 1:1000

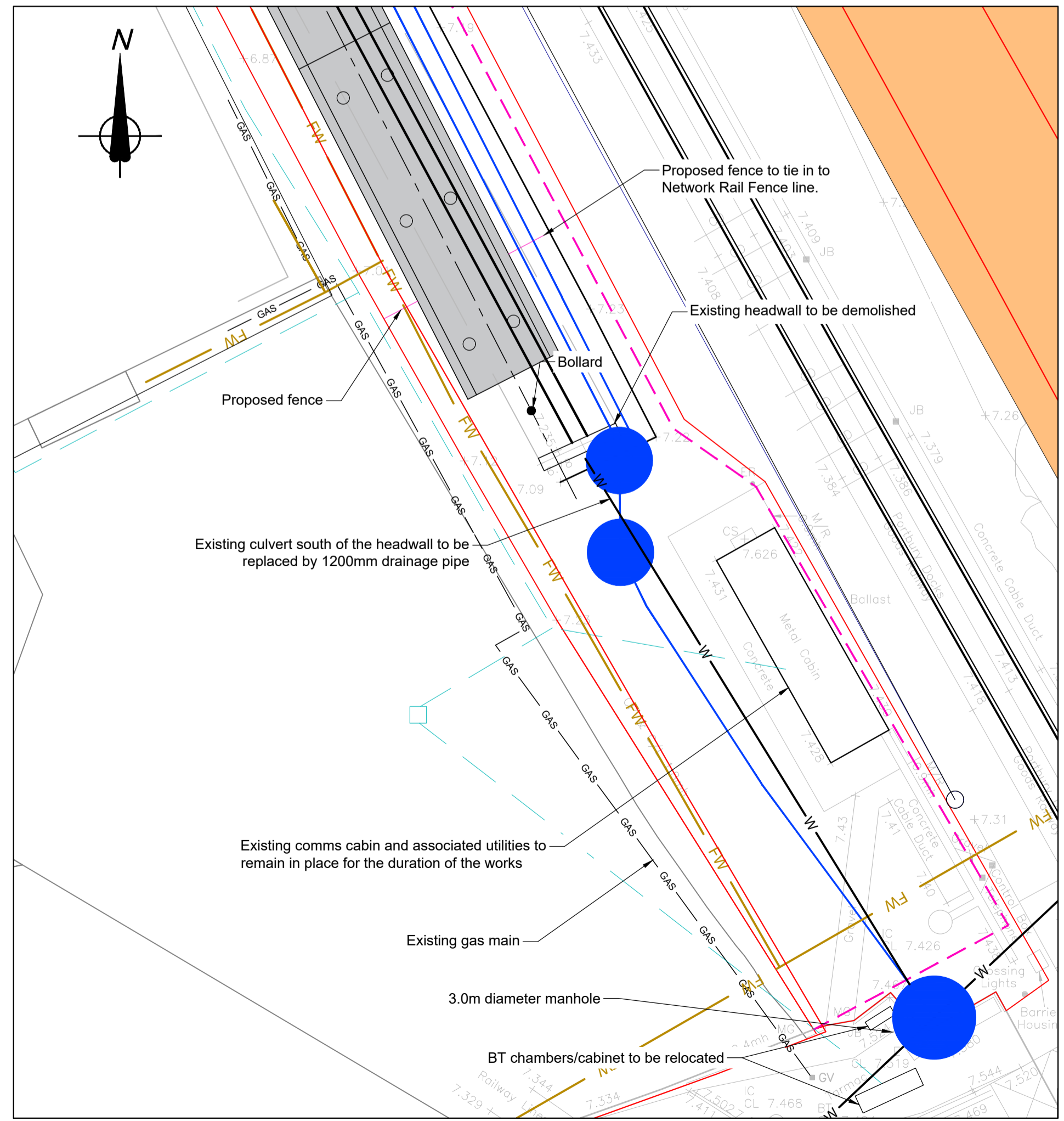

DETAIL A
Scale 1:150

- NOTES:
1. All levels are in meters AOD unless stated otherwise.
 2. This drawing should not be scaled and only written dimensions should be used
 3. Drawing to be read in conjunction with drg. 674946.BD.29.01-SK35 and 674946.BD.29.01-SK36
 4. Man hole covers to be 2.4m diameter unless noted otherwise.

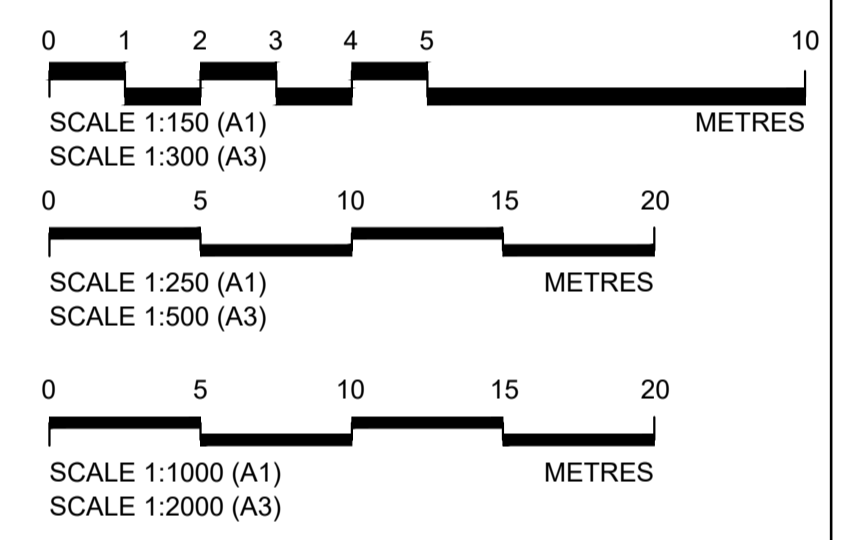
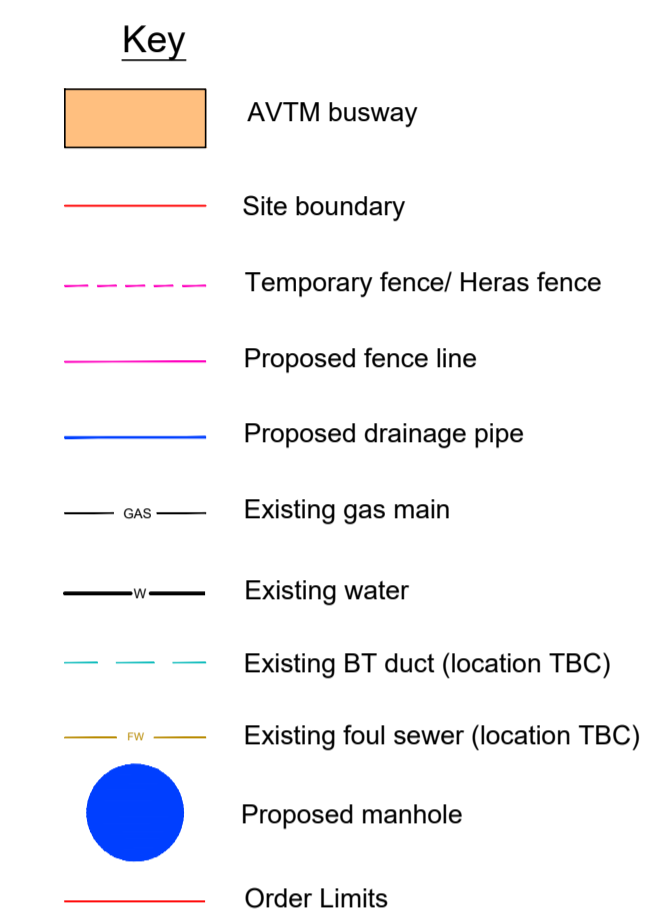

DO NOT SCALE. This drawing is to be read in conjunction with all relevant Architects, Engineers and Specialist Manufacturer's drawings and specifications. If in doubt please consult the Engineer.

This map is reproduced from Ordnance Survey material by Helcrow on behalf of North Somerset Council with the permission of the Controller of Her Majesty's Stationary Office, © Crown copyright. Unauthorised reproduction infringes Crown copyright and may lead to prosecution or civil proceedings. Licence Number: 100023317

Rev	By	Chkd	Apprd	Date	Description
B	DHP	ADL	ADL	10/10/2018	Minor amendments
A	FG	ADL	ADL	22/08/2018	Issue for 200 Application, drawing previously called 674946-CHE-SBR-411A-GR-CB-2016



CH2M HILL
1 The Square Temple Quay Bristol BS1 6DG
Tel +44 (0)117 910 2580 Fax +44 (0)117 910 2581
www.ch2m.com



Project
**PORTISHEAD BRANCH LINE
(METROWAY PHASE 1)**

Drawing
**ASHTON VALE ROAD
PEDESTRIAN RAMP DESIGN**

Drawn by: FG	Date: 17/04/2018
Checked by: SW	Date: 17/04/2018
Approved by: JM	Date: 17/04/2018
Drawing No.	Revision
674946.BD.29.01-SK34	B

Drawing Scale: AS SHOWN AT A1

Drawing file path & name: I:\Projects\674946 NSC - 2016 Bristol Framework\674946.BD.29.01 Ashton Vale Pedestrian Ramp\ASHTON VALE PEDESTRIAN RAMP DESIGN\ASHTON VALE PEDESTRIAN RAMP DESIGN.dwg